

# MAIZE MILL

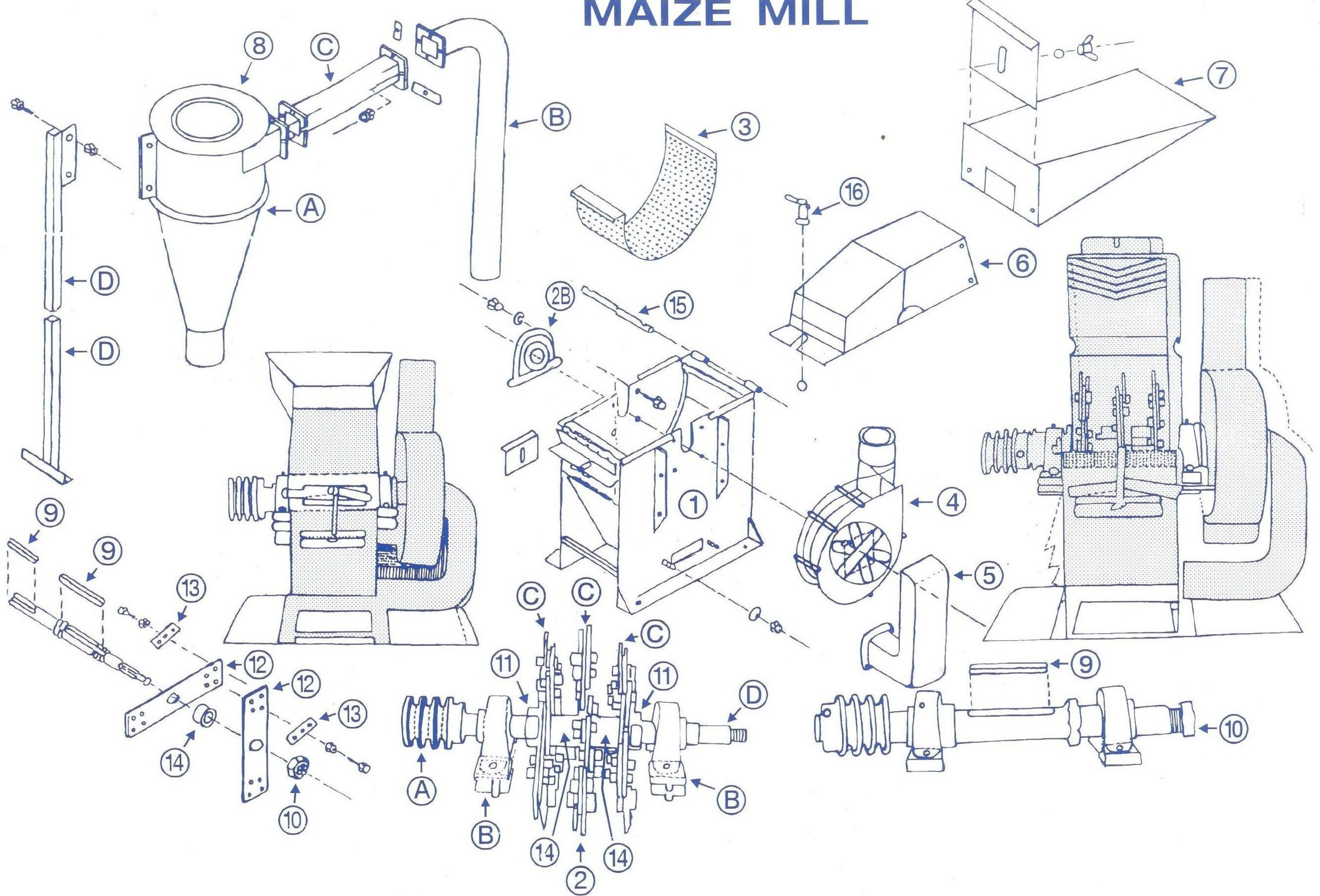

- |  |   |                             |
|--|---|-----------------------------|
| 1. Mill Body<br>(Available size in Thickness :<br>3mm., 4mm., 6mm., 8mm.)                    | 5. Side Blower Bend   | 10. Shaftin End Nut-1       |
| 2. Shaftin Assembly<br>A. Pulley B. Pillow Bearing<br>C. Beaters & Beaters Plates D. Shaftin | 6. Mill Body Top Cover  | 11. Beater Plate Lock Nut-2 |
| 3. Sieve   | 7. Hopper with Adjustable Window  | 12. Beater Plates           |
| 4. Side Blower Complete with Roter   | 8. Cyclone Assembly<br>A. Cyclone B. Bended Pipe<br>C. Cyclone Connecting Pipe<br>D. Stand Pipe-3 | 13. Beater                  |
|  | 9. Shaftin Lock Key   | 14. Shaftin Bush-2          |
|  |   | 15. Top Cover Hinges        |
|  |   | 16. Cover Lock              |

1. 12" x 8" cast rollers for crushing.
2. Hopper with even feeding system.
3. Adjustable rollers device for fine/coarse grinding without screen.
4. Approx. out put 800 kg. to 1200 kg. per hour.
5. Can be designed as per customer's need.
6. Available in different sizes.



## salt crusher 128

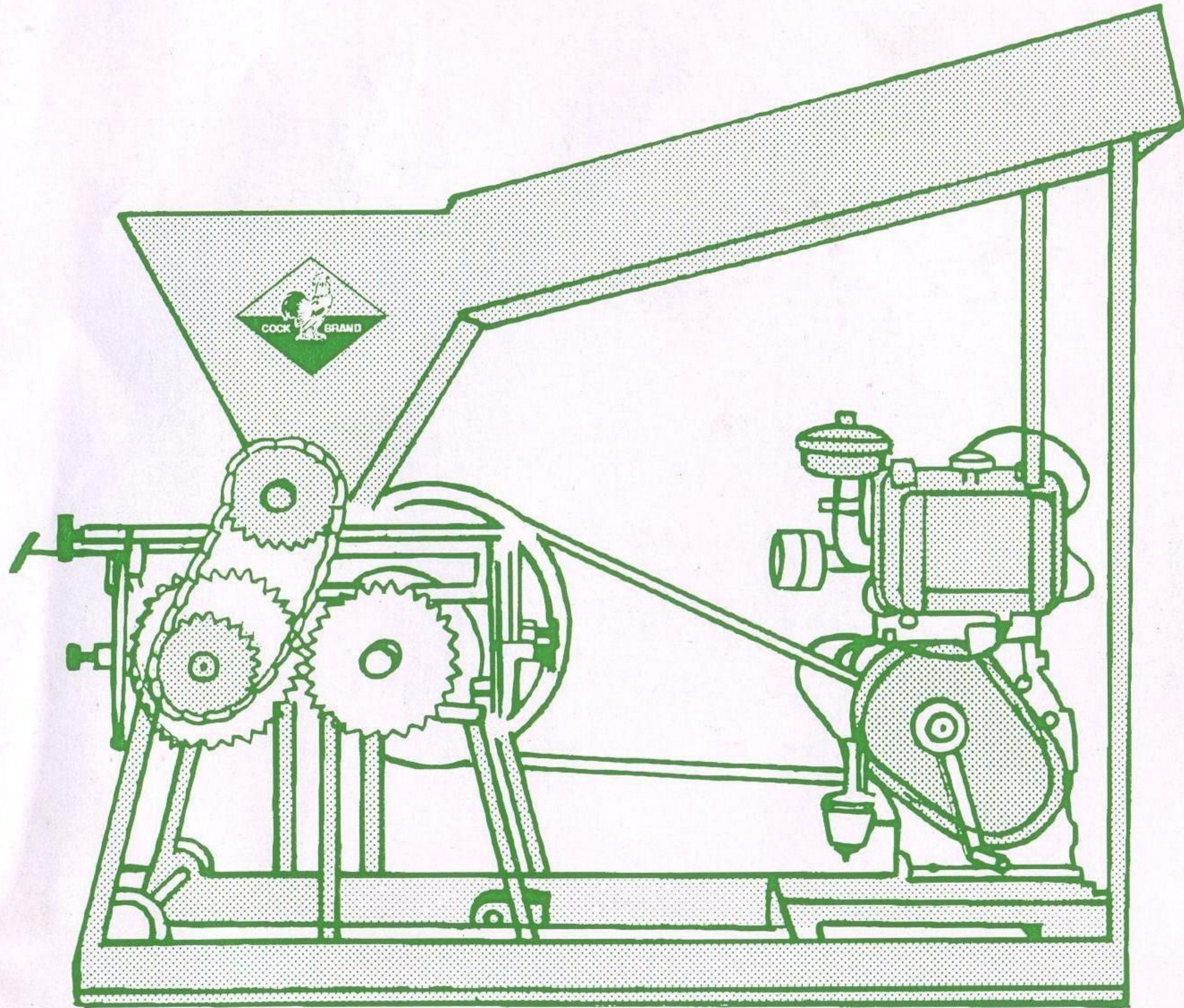

## maize mill

